

© 2022 CONNELLROBERTSON, INC. 2/8/2022 9:25:54 AM C:\Reel Projects\2021\148.00_21_Frost Bank Tesoro Arch. Central.dwg (REVISED) 14

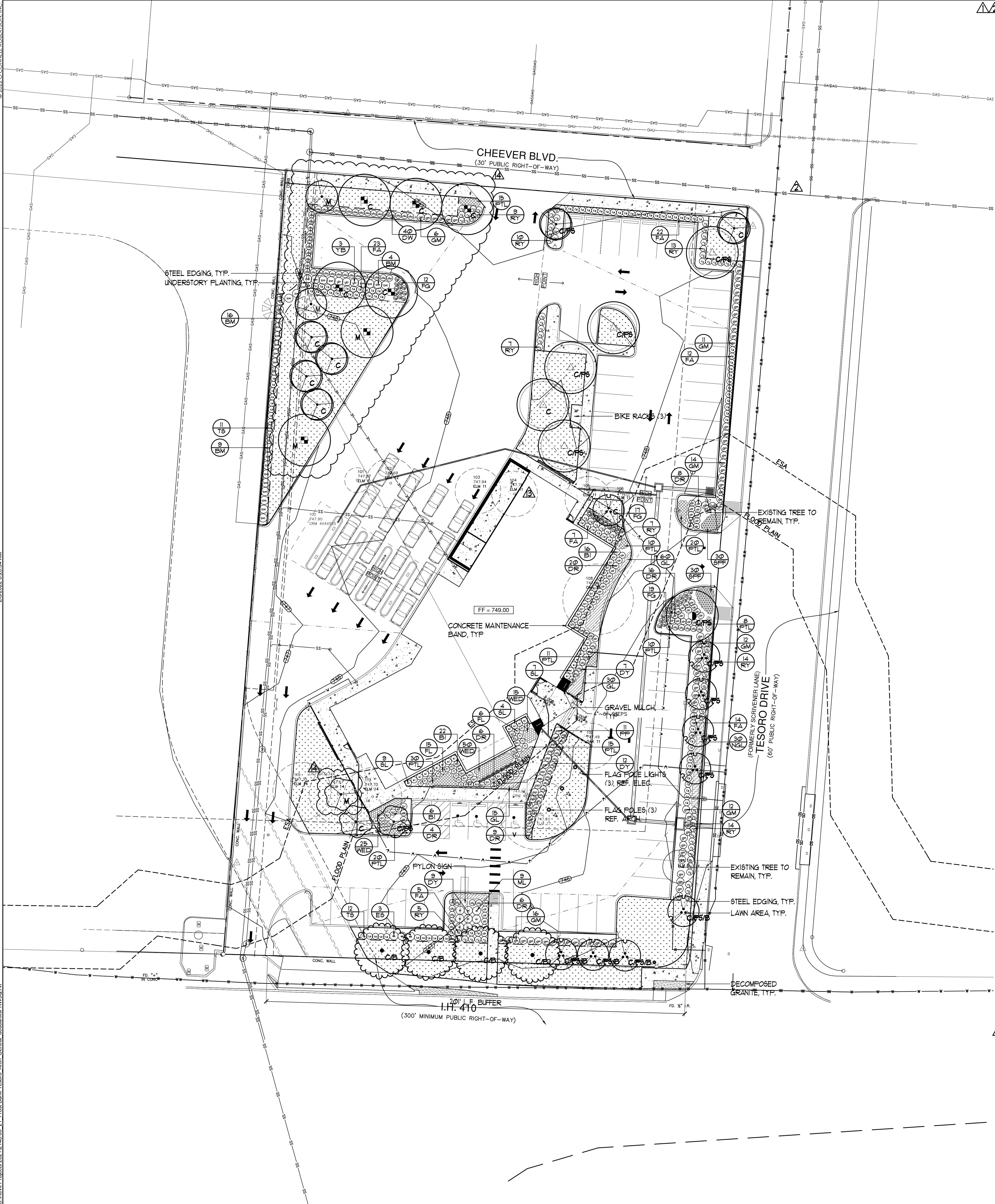

TREES					
SYMBOL	QTY.	COMMON / BOTANICAL NAME	CONT.	CALIFER	HEIGHT
5	5 ORD.	BURR OAK QUERCUS MACROCARPA	200 GAL	5" CAL.	12'-14' HT.
5	2 MITIG.				
5	5 ORD.	SHUMARD RED OAK QUERCUS SHUMARDII	300 GAL	6" CAL.	14'-16' HT.
1	1 ORD.	CHINQUAPIN OAK QUERCUS CHINQUAPIN	100 GAL	4" CAL.	10' HT.
5	5 ORD.	CEDAR ELM ULMUS CRASSIFOLIA	200 GAL	5" CAL.	12'-14' HT.
9	9 ORD.	TEXAS REDBUD CERCIS TEXANA	45 GAL	3" CAL.	5'-6' HT.
2	2 ORD.	TEXAS MOUNTAIN LAUREL SEPHORA SECUNDFLORA	54B	2" CAL.	5'-6' HT.
1	1 MITIG.				
6	6 ORD.	DESERT WILLOW CHILLOPSIS LINEARIS 'BUBBA'	30 GAL	2" CAL.	5'-6' HT.
2	2 MITIG.	TREE YAUPOIN ILEX VOMITORIA	54B	3" CAL.	5'-6' HT.

ORDINANCE TREES COUNTED AT 15" CALIFER WITH REMAINING CALIFER TOWARD MITIGATION.
C. CANOPY TREE, PS. PARKING LOT SHADE TREE, B. BUFFER TREE.
MITIGATION TREE: 100% CALIFER COUNTED TOWARD MITIGATION CREDIT. MITIGATION: M

SHRUBS			
SYMBOL	QTY.	COMMON / BOTANICAL NAME	SPACING
BI	43	BICOLOR IRIS DIETES BICOLOR	3 GAL 36" o.c.
BM	29	BIG MIMLY MUHLENBERGIA LINDHEIMERI	5 GAL 48" o.c.
DR	10	DRIFT ROSES CORAL/ ROSA MEIDRIFORA	5 GAL 36" o.c.
DW	40	DWARF WAX MYRTLE MYRTICA CERIFERA 'DON'S DWARF'	3 GAL 36" o.c.
DY	35	DWARF YAUPOIN ILEX VOMITORIA 'NANA'	3 GAL 36" o.c.
ES	3	EVERGREEN SUMAC RHUS VIRENS	5 GAL 48" o.c.
FA	83	FLAME ACANTHUS ANISCANTHUS QUADRIFIDUS VAR. WRIGHTII	3 GAL 36" o.c.
FG	48	MEXICAN FEATHER GRASS NASELLA TENUISSIMA	1 GAL 24" o.c.
FL	21	FLAX LILY DIANELLA TASMANICA	1 GAL 24" o.c.
GM	71	GULF MIMLY MUHLENBERGIA CAPILLARIS 'REGAL MIST'	5 GAL 36" o.c.
ML	9	MOUNTAIN LAUREL SEPHORA SECUNDFLORA	5 GAL 48" o.c.
PP	11	PINK PARADE YUCCA HESPERALOE X 'FERPU'	5 GAL 42" o.c.
RY	79	RED YUCCA HESPERALOE PARVIFLORA	3 GAL 36" o.c.
SL	20	SUNSHINE LIGUSTRUM LIGUSTRUM SINCE'S 'SUNSHINE'	5 GAL 36" o.c.
TS	23	TEXAS SAGE LEUCOPHYLLUM X 'HEAVENLY CLOUD'	3 GAL 36" o.c.
YB	3	YELLOW BELLS TECOMA STANS VAR. SPARKLETTE	5 GAL 48" o.c.

PERENNIALS AND GROUNDCOVERS			
SYMBOL	QTY.	COMMON / BOTANICAL NAME	SPACING
GL	28	GIANT LIRIOPE LIRIOPE GIGANTEA	1 GAL 18" o.c.
PTL	41	PURPLE TRAILING LANTANA LANTANA MONTEVIDENSIS 'PURPLE'	1 GAL 18" o.c.
NGL	26	NEW GOLD LANTANA LANTANA X 'NEW GOLD'	1 GAL 24" o.c.
SFF	48	SKULLCAP SCUTELLARIA SUFFRUTESCENS	1 GAL 18" o.c.
MED	85	WEDELIA WEDELIA TRILOBATA	1 GAL 18" o.c.

LAWN		
SYMBOL	COMMON / BOTANICAL NAME	CONT.
1	BERMUDA GRASS SOD CYNODON DACTYLON 'TIF TUFF'	SOLID SOD

TREE CANOPY CALCULATIONS		
TOTAL SITE AREA	83,048.31	S.F.
REQUIRED TREE CANOPY (25%)	20,762.08	S.F.
PROVIDED TREE CANOPY (25%)	20,762.08	S.F.
EXISTING TREE CREDIT (100%)	1,750.00	S.F.
EXISTING TREES: 2 @ 875 =	1,750.00	
PROPOSED TREE CREDIT (90%)	10,945.00	S.F.
PROPOSED TREE: 10 @ 12,000 =	12,000.00	
PROPOSED TREE: 5 @ 875 =	4,375.00	
PROPOSED TREE: 11 @ 215 =	4,615.00	

ADJOINING STREET BUFFER		
LOOP 410 (MAJOR ARTERIAL - TYPE B) 201.0 L.F.		
REQ. WIDTH	15'	
PROVIDED WIDTH (MINIMUM)	15'	
REQ. SHADE TREES (2/100 L.F.)	4	
PROVIDED SHADE TREES	4	
REQ. UNDERSTORY TREES (2/100 L.F.)	4	
PROVIDED UNDERSTORY TREES	4	
REQ. LARGE SHRUBS (6/100 L.F.)	12	
PROVIDED SMALL SHRUBS	12	
REQ. MEDIUM SHRUBS (8/100 L.F.)	16	
PROVIDED SMALL SHRUBS	16	
REQ. SMALL SHRUBS (6/100 L.F.)	12	
PROVIDED SMALL SHRUBS	12	

LANDSCAPE CALCULATIONS		
PARKING LOT SHADING		
PARKING LOT AREA	20,330.93	S.F.
REQUIRED SHADING (25%)	5,082.73	S.F.
PROVIDED SHADING (31.9%)	1,712.50	S.F.
EXISTING TREES		
2 @ 875 = 875.00 X 100% =	1,750.00	
TREES WITHIN 12' OF PARKING LOT		
4 @ 1200 = 4800.00 X 50% =	2,400.00	
5 @ 875 = 4375.00 X 50% =	2,187.50	
10 @ 215 = 2,150.00 X 50% =	1,075.00	
ELECTIVE CRITERIA REQUIRED	10	PTS
ELECTIVE CRITERIA PROVIDED	13	PTS
PARKING LOT SHADING	20	
PARKING LOT SCREENING	30	
TREE PRESERVATION	8	
UNDERSTORY PLANTING	15	

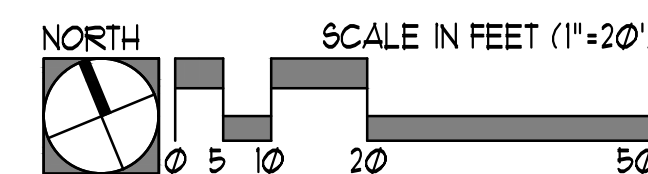

© 2022 CONNELLROBERTSON, INC.

2/8/2022 9:25:54 AM

C:\Reel Projects\2021\148.00_21_Frost Bank Tesoro Arch. Central.dwg (REVISED) 14

REGISTERED LANDSCAPE ARCHITECT
STATE OF TEXAS

05/05/22
Project No. 21-148.00
CONTRACT DOCUMENTS

Landscape Plan
L1.0